

CUSTOMER PART No.

CUSTOMER

**CAN ART STD.**

DIE No.

**EH05048**

DESCRIPTION

**2.500" O.D. x 0.065" THK. ROUND TUBE**

PROPOSAL No.

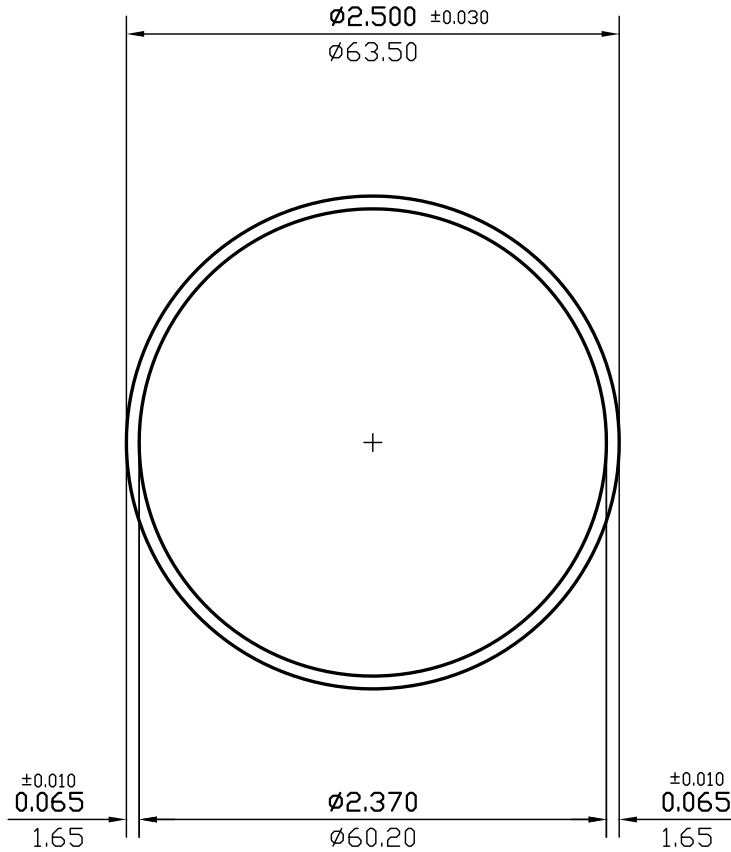

NOTE: BREAK ALL CORNERS WITH 0.015" (.38 MM) RADIUS UNLESS OTHERWISE NOTED. STANDARD TOLERANCES TO APPLY UNLESS OTHERWISE SPECIFIED.

WALL THICKNESS  $\pm 0.010$   
**0.065 (1.65)** EXCEPT AS SHOWN

DATE	REV	DESCRIPTION	BY		
03/10/23	2	REMOVED ALLOY	JASON		
08/06/99	1	REDRAWN	P.M.		
EST.AREA	0.497	IN. <sup>2</sup>	EST.AREA	321	MM. <sup>2</sup>
EST.WT.	0.587	LBS/FT.	EST.WT.	0.873	KG/M.
EST.PER.	15.300	IN.	EST.PER.	388.6	MM.
OUT PER.	7.854	IN.	OUT PER.	199.5	MM.
C.C.D.	2.500	IN.	C.C.D.	64	MM.
FACTOR	26	FINISH	M/F	ALLOY & TEMP.	
CKD BY		SCALE	1:1	DWN BY	C.P. DATE 07/21/93

**CAN ART**

ALUMINUM EXTRUSION INC.

85 PARKSHORE DRIVE  
 BRAMPTON, ONT L6T 5M1  
 TEL. NO. (905) 791-1464  
 FAX NO. (905) 791-9151  
 E-MAIL: canart@canart.com

THIS DRAWING IS NOT NECESSARILY A COPY OF YOUR ORIGINAL. PLEASE APPROVE DIMENSIONS AND TOLERANCES INDICATED. CAN ART ASSUMES NO RESPONSIBILITY EITHER TECHNICAL OR LEGAL FOR HAVING THIS SHAPE MADE. THE CUSTOMER AGREES TO FULLY PROTECT CAN ART ALUMINUM FROM CLAIMS OF OTHERS RESULTING FROM THIS SHAPE.

SIGNED: \_\_\_\_\_ DATE: \_\_\_\_\_